

# Sanifount® Installation Instructions

## INSTALLATION

The Sanifount® is supplied complete with all accessories.

### PART 1 - USE ONLY THE ORIGINAL PARTS

#### STEP 1. TAKE OFF THE COMPLETE PRE-ASSEMBLED DISTRIBUTION HEAD AS FOLLOWS:

- A) Remove the stainless steel cover of the distribution head.
- B) Open dispenser with supplied key.
- C) Pull the cover forward while gently lifting the back of the lid (figure 1).
- D) Unscrew A, A\* and B and remove the whole pre-assembled distribution head (figure 2).

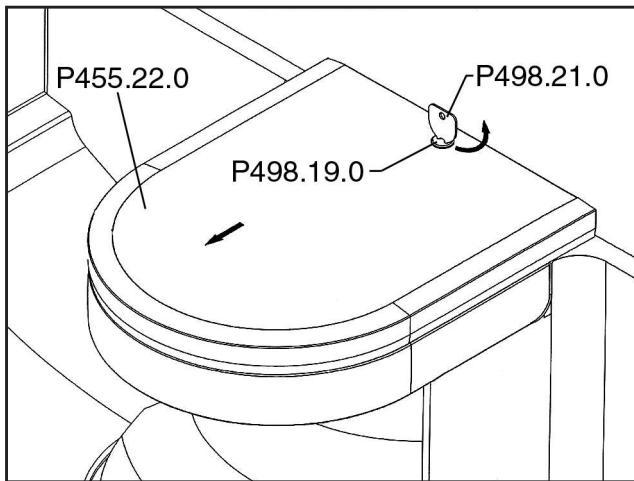

Figure 1

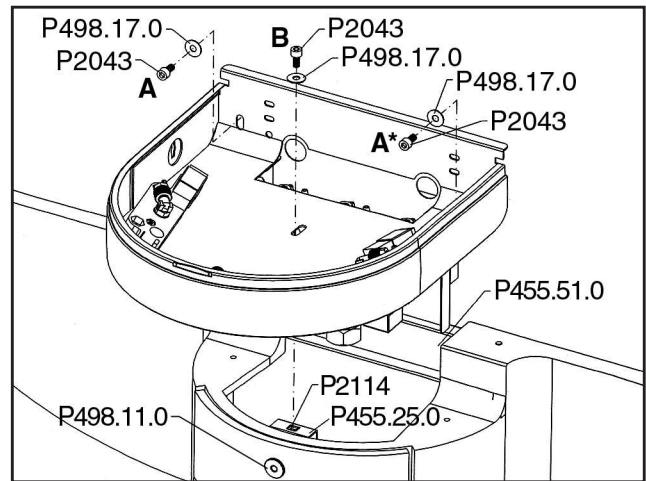

Figure 2

**STEP 2. MOUNT THE UNIT ACCORDING TO THE ROUGH IN INFORMATION** (see rough-in's on page 2 and 3).

**STEP 3. REMOVE THE INSPECTION PANEL AT THE BOTTOM OF THE SANIFOUNT®** (see figure 3).

- A) Bolts B and B should stick approximately 3/4" out of the wall.
- B) Hook the bowl over the screws and tighten screw securely making sure bowl is level.
- C) Install P455520 washers (labeled C and C) and tighten.

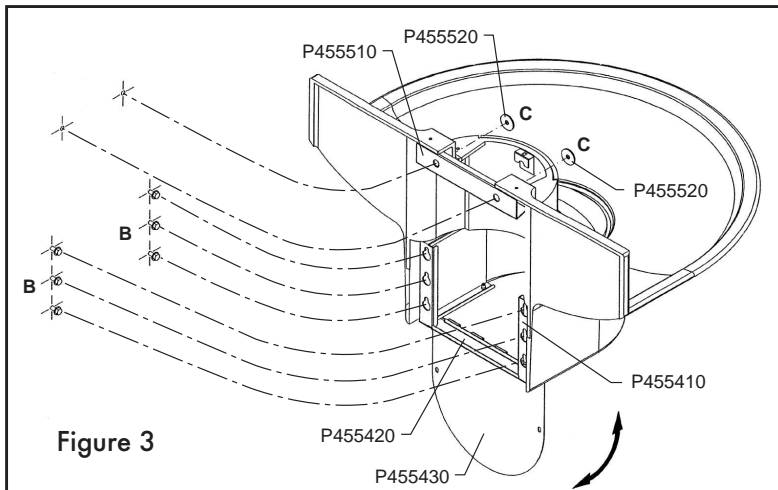

Figure 3

**NOTE:** Only use the original components supplied. Clean all water lines thoroughly before installation of Sanifount®. Always turn off the main water supply of both hot and cold water during installation or maintenance.

# Sanifount® Installation Instructions

INTERSAN® SANIFOUNT® ASSEMBLY

## Sanifount® - 3 Station

### Rough-In Information

**IMPORTANT:** Intersan recommends a minimum of 1000lbs. of pull out strength per wall anchor.

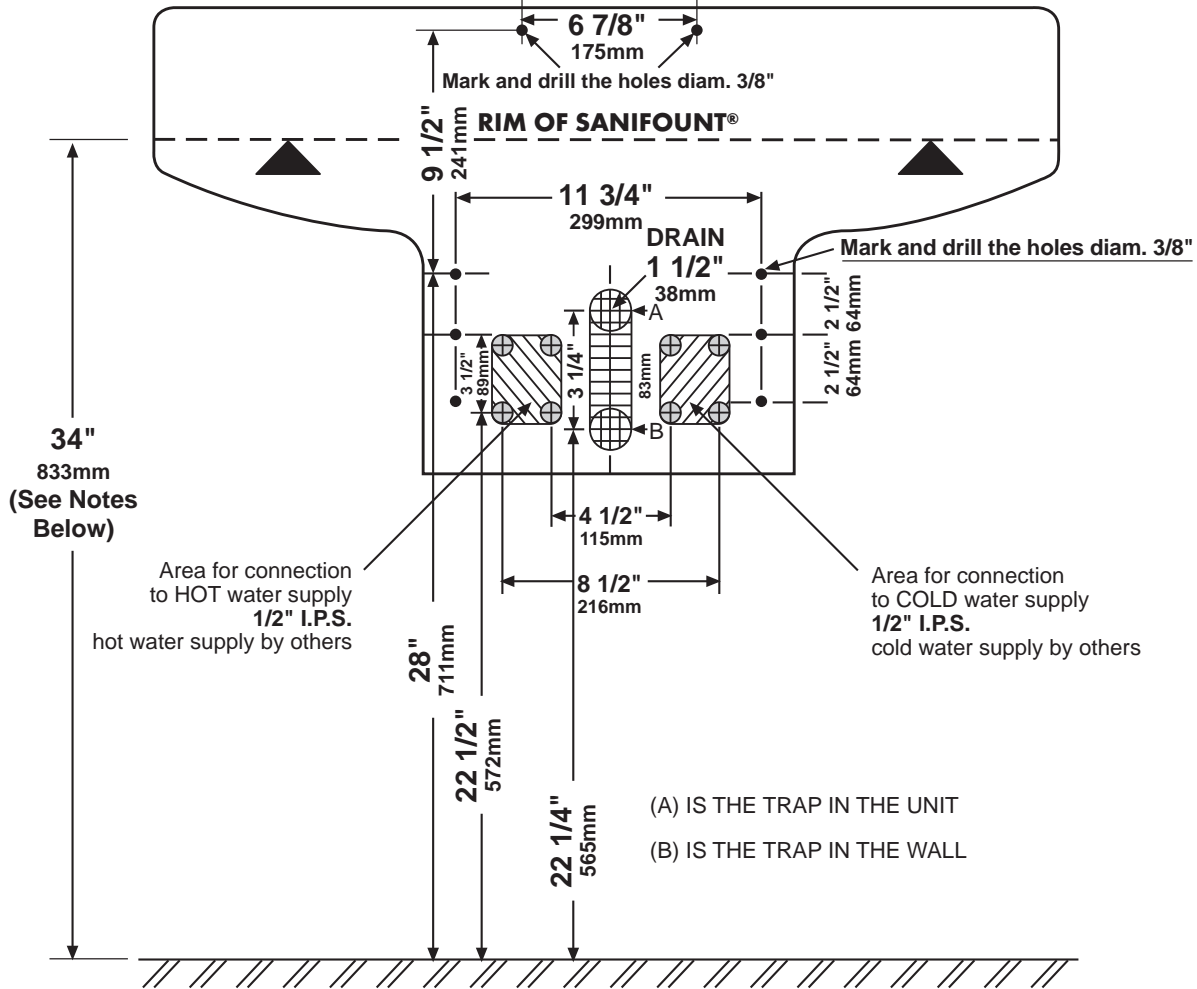

NOTES: ADJUSTMENTS TO VERTICAL HEIGHT ADJUSTMENTS BY RIM REQUIREMENT		
Rim Height	Barrier-Free Requirements - Compliance	Adjustment
34"	ADA, TAS and CAL - Adult Height	None, See Above
32"	TAS - Juvenile Height: Grade 6 thru 8/9, Ages 11 thru 14/15	Subtract 2"
31"	ADA - Juvenile Height	Subtract 3"
30"	TAS - Juvenile Height: Grade Pre-K thru 5/6, Ages 4 thru 10/11	Subtract 4"
29"	California - Elementary Height (E): Ages 6 thru 11	Subtract 5"
24"	California - Juvenile Height (K): K and Pre-School, Ages 3 thru 5	Subtract 10"

All information including dimensions, changes in design, and material are subject to manufacturer's change without formal notice and without obligation. INTERSAN assumes no responsibility for use of superceded or voided information.

Protected by European and U.S. registered and pending patents.

# Sanifount® Installation Instructions

INTERSAN® SANIFOUNT® ASSEMBLY

## Sanifount® - 4 Station

### Rough-In Information

**IMPORTANT:** Intersan recommends a minimum of 1000lbs. of pull out strength per wall anchor.

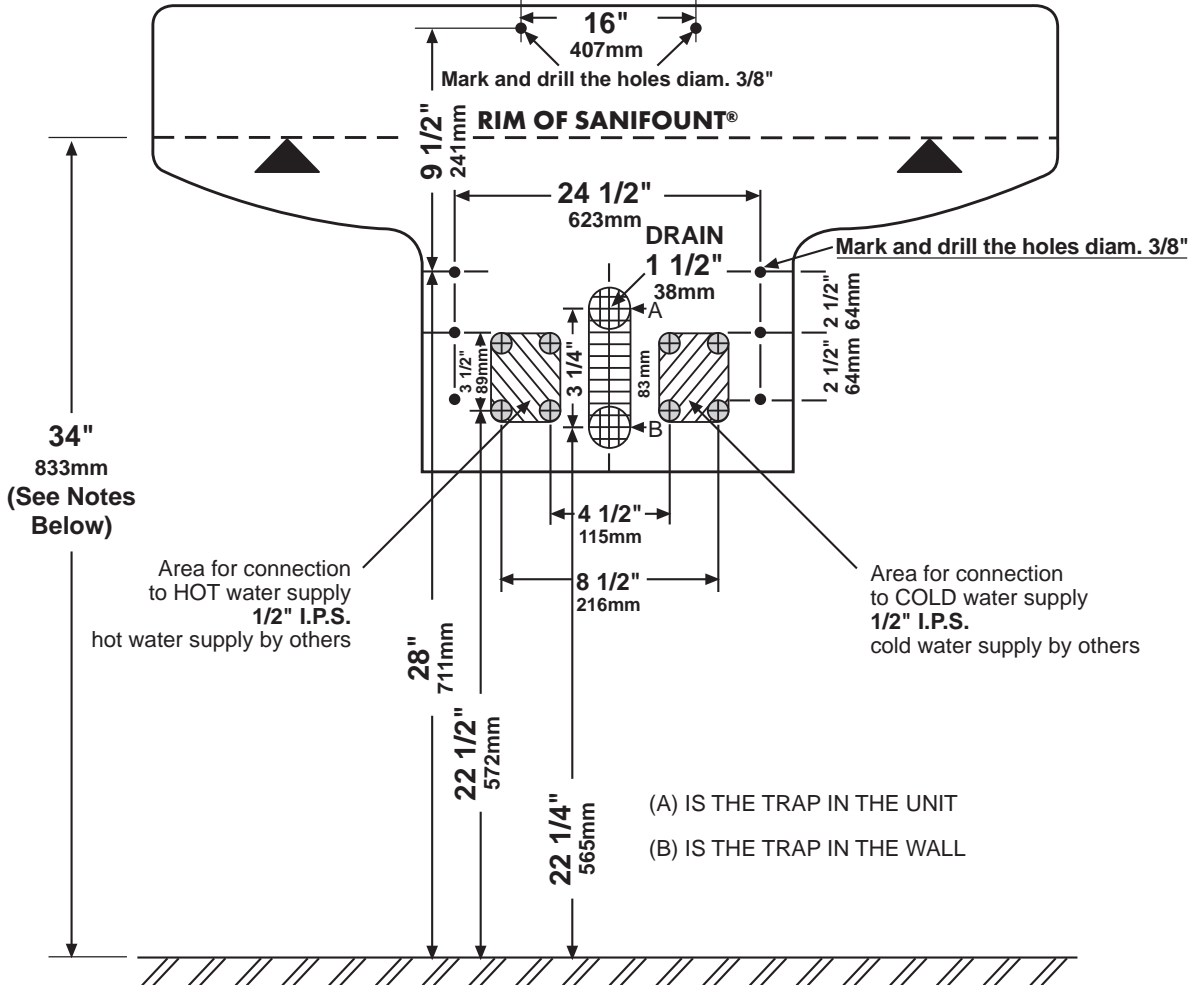

NOTES: ADJUSTMENTS TO VERTICAL HEIGHT ADJUSTMENTS BY RIM REQUIREMENT		
Rim Height	Barrier-Free Requirements - Compliance	Adjustment
34"	ADA, TAS and CAL - Adult Height	None, See Above
32"	TAS - Juvenile Height: Grade 6 thru 8/9, Ages 11 thru 14/15	Subtract 2"
31"	ADA - Juvenile Height	Subtract 3"
30"	TAS - Juvenile Height: Grade Pre-K thru 5/6, Ages 4 thru 10/11	Subtract 4"
29"	California - Elementary Height (E): Ages 6 thru 11	Subtract 5"
24"	California - Juvenile Height (K): K and Pre-School, Ages 3 thru 5	Subtract 10"

All information including dimensions, changes in design, and material are subject to manufacturer's change without formal notice and without obligation. INTERSAN assumes no responsibility for use of superceded or voided information.

Protected by European and U.S. registered and pending patents.

## Sanifount® Installation Instructions

INTERSAN® SANIFOUNT® ASSEMBLY

### PART 2 - STOP BALL VALVES

#### STEP 4. INSTALLING STOP BALL VALVES (1 OR 2) ONTO THE SUPPLY LINE (S) ON THE WALL.

- A) Remove 3/8" compression fitting (#3) and white compression washer (#2) from outlet of the stop ball valve (#1);
- B) Push compression fitting (#3) and then the white compression washer (#2) over wall flange of the flexible supply line and attach to the outlet of the stop ball valve (#1).

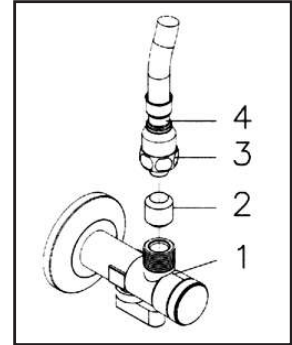

### PART 3 - RE-INSTALL THE COMPLETE DISTRIBUTION HEAD ACCORDING TO FIGURE 4

#### STEP 5.

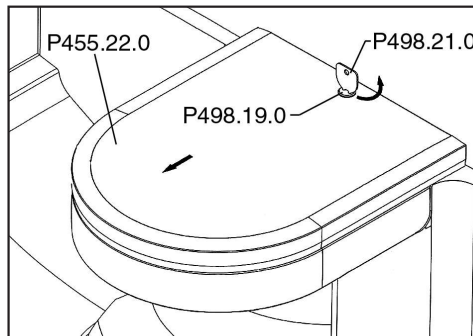
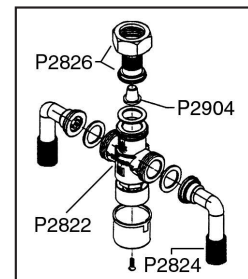

Figure 4

### PART 4 - CONNECT SUPPLY FLEXIBLES FROM STOP BALL VALVES TO TMV OR COLD WATER

#### STEP 6. CONNECTION OF THE TMV TO THE FLEXIBLE SUPPLY LINES

- A) Secure both elbow couplings (P2824) firmly to the cold and hot water entrance of the TMV.
- B) Place both 1/2" compression washers (P430060) in the 1/2" compression nuts and attach the flexible supply lines and mount to the elbow-couplings (P2824).



#### STEP 7. REMOVE THE 3/8" COMPRESSION FITTING (#3) AND WHITE COMPRESSION WASHER (#2) FROM OUTLET OF THE STOP BALL VALVE (P2711).

#### STEP 8. PUSH COMPRESSION FITTING (#3) AND THEN THE WHITE COMPRESSION WASHER (#2) OVER THE WALL FLANGE (#4) OF THE FLEXIBLE SUPPLY LINE, AND ATTACH TO THE OUTLET OF THE STOP BALL VALVE (P2711).

**IMPORTANT:** make sure to connect the cold water flexible to the cold inlet, and the hot water flexible to the hot water inlet, connection of the cold water flexible supply should be to the right of hot water supply to the left when the outlet of the TMV is pointing upwards.

### PART 5 - CONNECT WASTE PER LOCAL BUILDING CODES

## Sanifount® Installation Instructions

INTERSAN® SANIFOUNT® ASSEMBLY

### PART 6 - FINALIZING THE INSTALLATION

- STEP 9.** A) Connect the lithium battery pack (10.8v) to the battery lead connected to the gray microprocessor.  
B) Depress reset button mounted on the rear of the sprayhead. Wait approximately 30 seconds for changing of the capacitors. After 30 seconds each station should be operational. If stations do not operate, recheck steps. If this does not occur, it may be necessary to manually reset. Instructions are located on the inside cover of the gray microprocessor.
- STEP 10. PLACE THE SOAP BAGS IN THE RESERVOIR IF OPTIONAL LIQUID SOAP IS SUPPLIED. ONCE CARTRIDGE HAS BEEN FILLED, USE SYRINGE TO PRIME EACH SOAP NOZZLE.**
- STEP 11. MOUNT THE COVER ON THE HEAD (figure 1).**
- STEP 12. REINSTALL DRAIN COVER (figure 3).**

### MAINTENANCE

#### PART 1 - CLEANING THE COVER

The cover of the Sanifount® is made from stainless steel. When cleaning the cover, observe the following instructions:

- STEP 1. CLEAN THE SURFACE WITH A WET CLOTH AND MILD DETERGENT. FINISH WIPING USING A DRY CLOTH. NEVER USE ABRASIVE CLEANERS, THEY WILL DAMAGE THE SURFACE OF THE COVER. DO NOT EXPOSE THE FIXTURE TO STEAM.**

**CAUTION:** Do not damage the sensor while cleaning.

#### PART 2 - CLEANING THE STRAINER SCREENS

- STEP 2. REGULARLY CLEAN THE STRAINER SCREENS OF BOTH STOP BALL VALVES.**
- A) Close the stop ball valve (P2711) and remove its strainer cap (#3) by turning it counter clockwise.  
B) Remove the strainer screen (#2) which is positioned inside the strainer cap (#3) and clean it. If the strainer screen has accumulated large amounts of lime deposits, it is recommended that you soak it in vinegar overnight to dissolve the lime deposits (=chemical reaction).  
C) Reposition the strainer screen inside the strainer cap and secure to the stop ball valve.

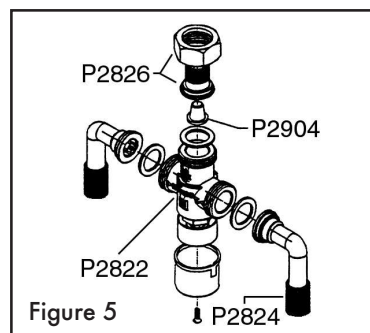
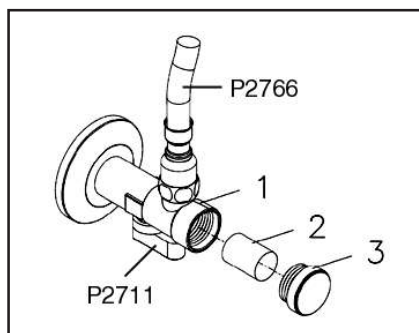

**NOTE:** Make sure not to damage the strainer screen, replace it when necessary. Repeat this procedure

## Sanifount® Installation Instructions

INTERSAN® SANIFOUNT® ASSEMBLY

for the second stop ball valve. Periodically clean the strainer screen between the thermostatic mixing valve and supply manifold (see figure 5). While both stop ball valves are in the off position remove the TMV and service the screen or replace when necessary (see figure 5)

### PART 3 - BATTERY REPLACEMENT

**STEP 3. REMOVE THE COVER OF THE SANIFOUNT®.**

**STEP 4. REMOVE THE OLD BATTERY AND CONNECT A NEW 10.8V BATTERY.**

### PART 4 - THERMOSTATIC MIXING VALVE

**STEP 5. ADJUSTMENT OF TEMPERATURE**

- A) Remove the screw and cap which conceals the control knob, move in the desired direction indicated (values are Celsius, from 40 to 44°C).
- B) Do not turn the control knob more than 2 full turns in the same direction. Make sure that the position of the control knob is at least one full turn from blockage.
- C) Reposition the screw and cap without over-tightening.

**STEP 6. DISCONNECTING THE HOT WATER SUPPLY**

**NOTE: If no hot water is available and/or in case of breakdown of the water heater, the hot water supply can be disconnected. This is necessary as otherwise no water will be available at all. The same instructions can be followed if no warm water is required at some time.**

- A) Remove the screw and cap which hides the control knob.
- B) Turn the control knob clockwise to the right.
- C) Reposition the cap without over tightening the screw.

**STEP 7. CLEANING THE SPRAY NOZZLE**

- A) Remove the nozzle of the Sanifount® using the special aerator nozzle key supplied.
- B) Insert the key in the slots of the nozzle and turn to the left (counterclockwise) until the nozzle is completely removed.
- C) Remove gasket, washer and vacuum breaker and clean those parts which are affected by lime or dirt.
- D) Reposition all elements in the nozzle in the correct order.
- E) Secure the nozzle to the faucet outlet, insert the special aerator key in the slots of the nozzle and turn to the right (clockwise) until blockage.

**STEP 8. CLEANING THE WATER PASSAGE OF THE SOLENOID VALVE (figure 6).**

- A) Remove the 4 round head screws (P2001) located on the top of the solenoid valve (black housing) and separate the electrical part of the valve from the water part;
- B) Remove core (B) and core spring (A) from the core housing (C);
- C) Clean core, core spring, core housing and water outlet of the solenoid valve;
- D) Replace core spring inside core, and reposition both elements inside the core housing (core spring first) such that core and core spring are retained by the magnet inside the solenoid valve;

# Sanifount® Installation Instructions

INTERSAN® SANIFOUNT® ASSEMBLY

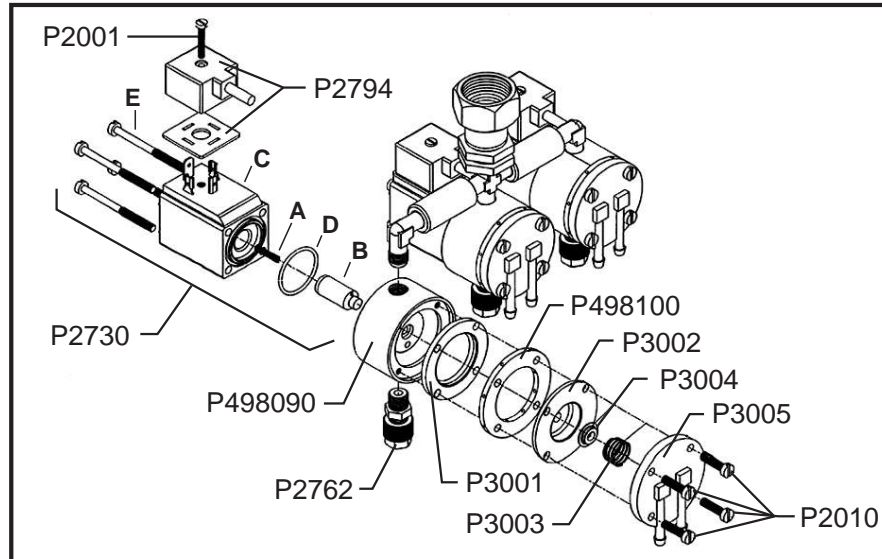

Figure 6

- E)** Place black O-ring (D), which joins the electrical and the water part of the valve, in its groove around the core housing, and re-position the electrical part on the water part of the valve;
- F)** Insert 4 round head solenoid screws (E) and tighten firmly.

# Sanifount® Installation Instructions

INTERSAN® SANIFOUNT® ASSEMBLY

## SANIFS23 (Shown with optional soap)

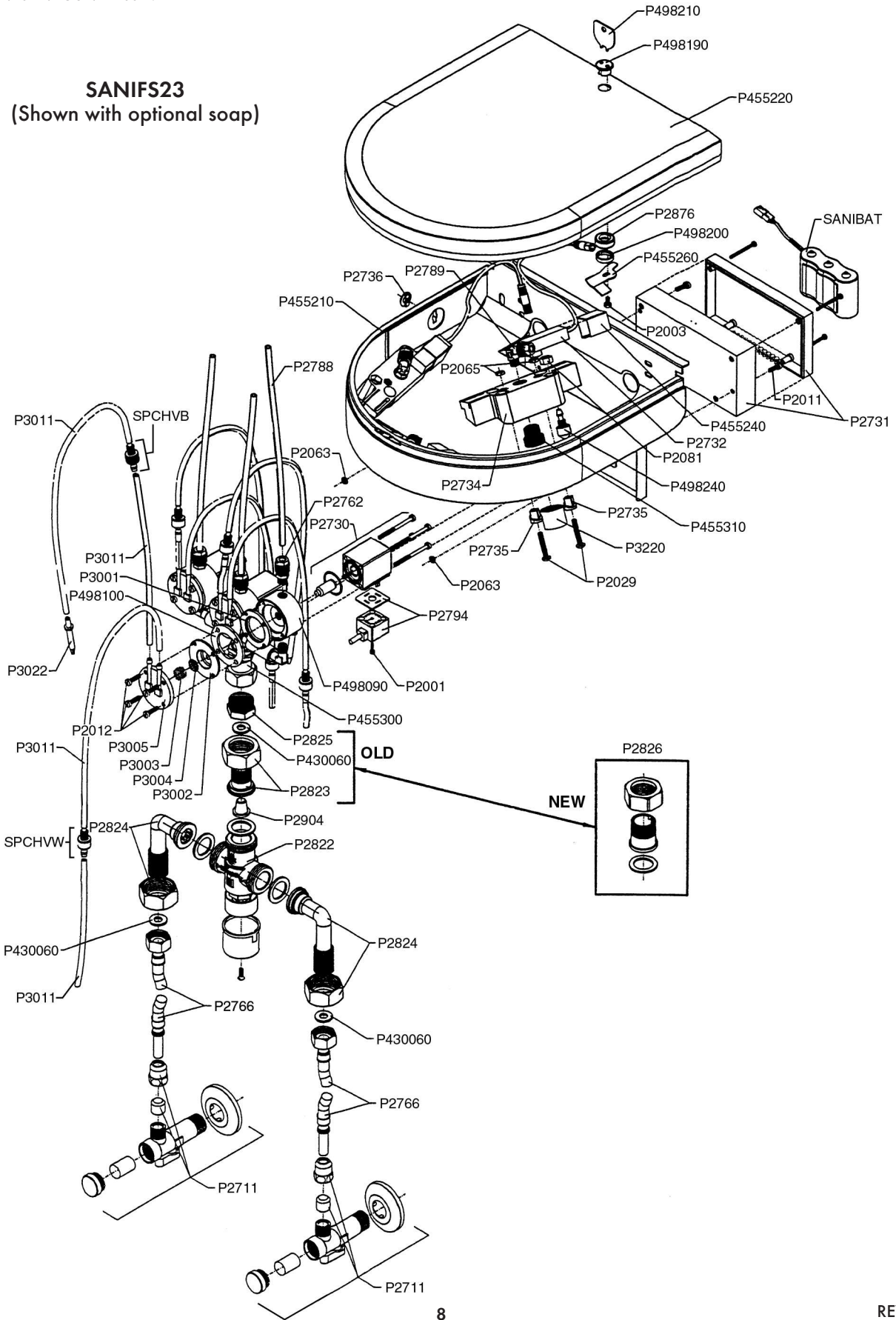



# Sanifount® Installation Instructions

INTERSAN® SANIFOUNT® ASSEMBLY

## SANIFS13 (Shown with optional soap)

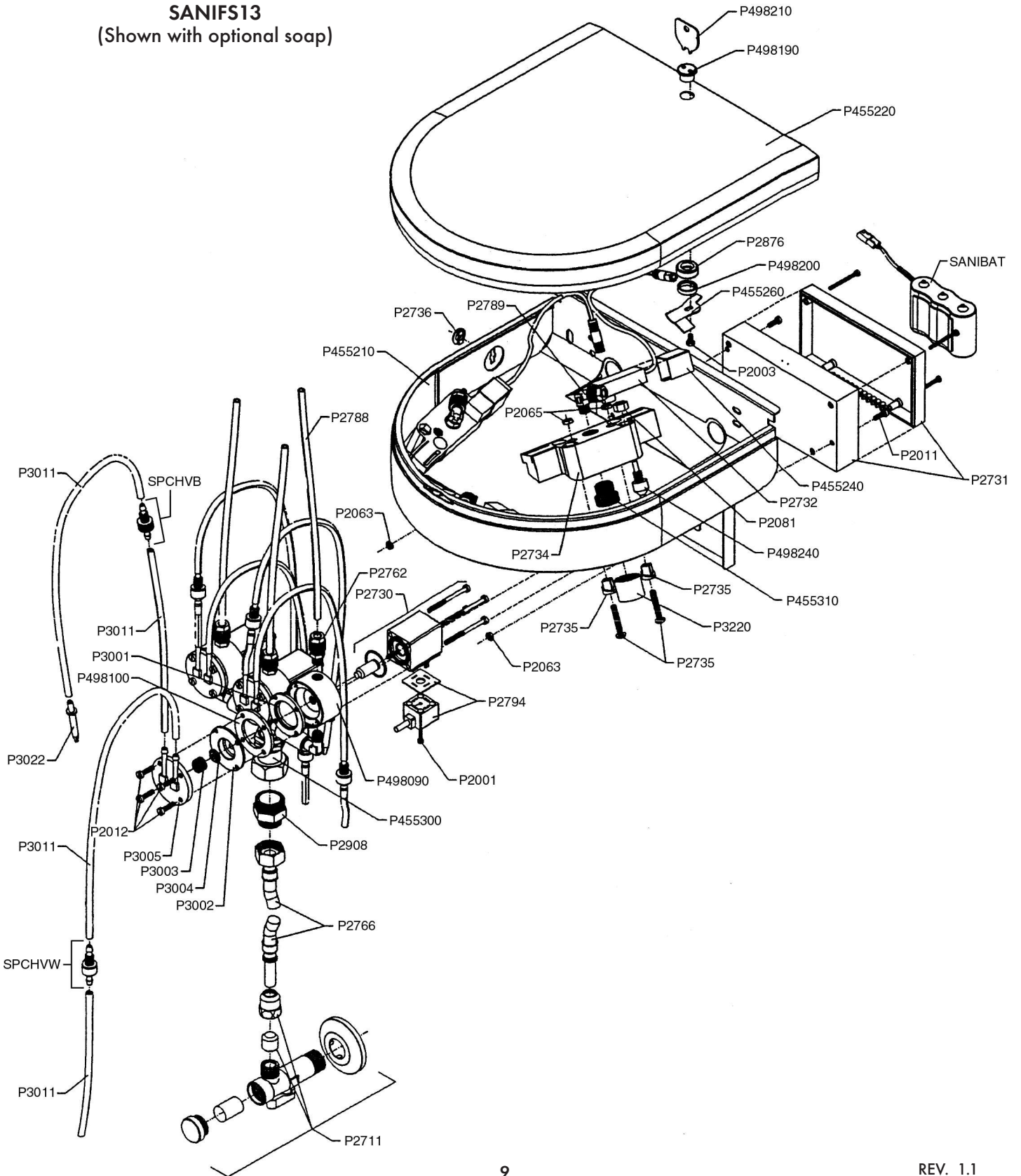

# Sanifount® Installation Instructions

INTERSAN® SANIFOUNT® ASSEMBLY

## SANIFS24 (Shown with optional soap)

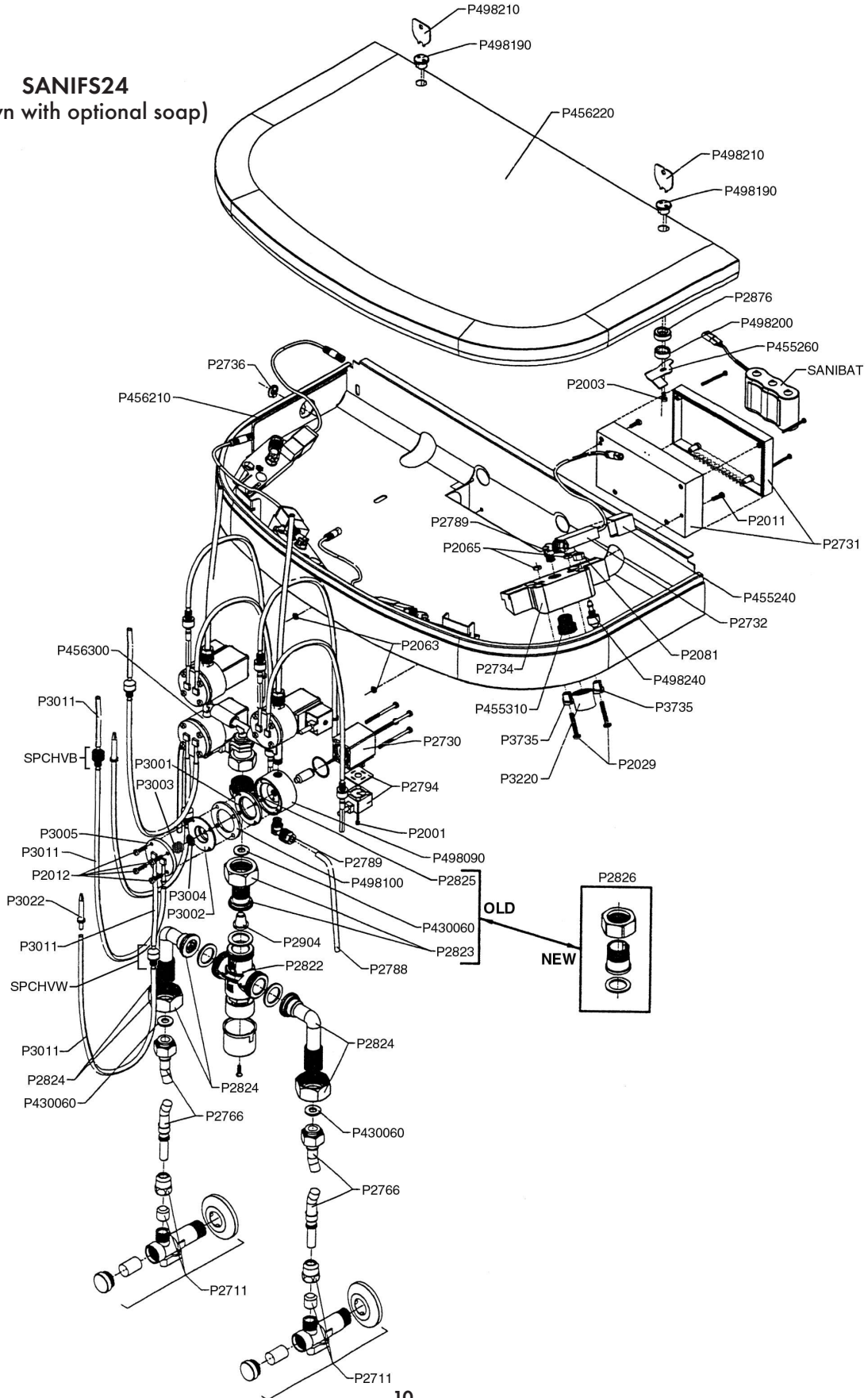

# Sanifount® Installation Instructions

INTERSAN® SANIFOUNT® ASSEMBLY

## SANIFS14 (Shown with optional soda)

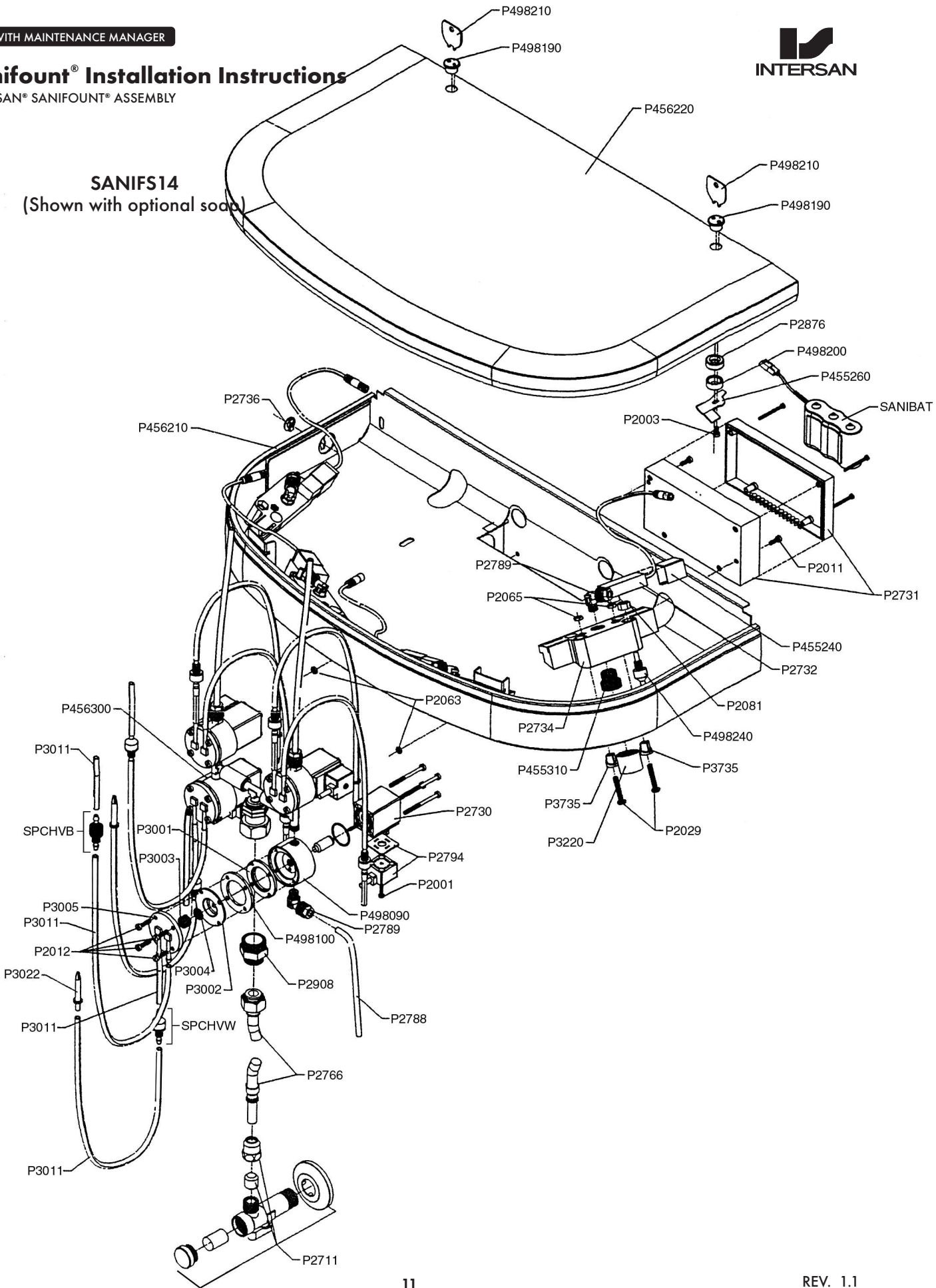

## Sanifount® Installation Instructions

INTERSAN® SANIFOUNT® ASSEMBLY

### CONSUMER NOTICE

This product contains chemicals known to the state of California to cause birth defects or other reproductive harm. This notice is a mandatory requirement by the state of California under current law. (Proposition 65.) Drinking water has been found to contain lead, some of which has been attributed to piping, lead solders and brass plumbing fittings. Water standing in a closed water system may dissolve lead out of the faucet and the rest of the plumbing system, particularly if the water is corrosive.

INTERSAN washfountains, automatic faucets, and hand washing systems are manufactured from the highest quality of materials available in the industry today. However, fittings made of brass contain minute of lead in alloy form which may be leached out when water is allowed to stand in the system. We suggest that you greatly reduce unnecessary exposure dissolved materials in your water supply by taking the following steps:

1. Never drink the first glass out of the tap when the water has been standing unused for several hours, during the day or overnight. Run the faucet for a few seconds to “flush it”.
2. Avoid drinking or cooking with water drawn from the hot water side of the tap.

### DAMAGE/SHORTAGE CLAIM

All INTERSAN products are carefully inspected prior to shipment from the Phoenix warehouse. Our responsibility as manufacturer of our products cease upon delivery in good order to any carrier or transportation company. All materials are shipped at the consignee’s risk. Since INTERSAN is not responsible for damage in shipment or storage, customers should carefully inspect all items at time of delivery and note any obvious damage on the delivery receipt. For the customer’s protection we recommend visual inspection of materials prior to signing carrier’s receipt. Such obvious or subsequently discovered damage must be reported in writing to the carrier in accordance with applicable regulations and time limits, usually 15 days of delivery. Claimed for shortages or variances must be submitted in writing within 10 days following receipt of invoice or shipment, otherwise they will not be honored.

**All information including dimensions are subject to manufacturer’s change without notice. INTERSAN assumes no responsibility for use of superseded or voided information.**

# *Warranty*

Intersan Manufacturing Company warrants to commercial and institutional purchasers only, each unit, free from defects in material and workmanship under normal use and service upon the following terms and conditions:

1. This warranty is limited to replacing or repairing at our option, transportation charges prepaid by the purchaser, any Intersan unit or part thereof which our inspection shall show to have been defective within the limitations of this warranty.
2. The period during which Intersan products are warranted is as follows:
  - Solidsan™ and stainless steel materials warranted for 5 years.
  - All other Intersan components warranted for 3 years (excluding batteries and common wear items such as diaphragms, washers, certain valves, etc.).
3. This warranty does not cover installation or any other labor charges and does not apply to any units which have been damaged by accident, abuse, improper installation, or improper maintenance.
4. The replacement or repair of defective units stated in this warranty shall constitute the sole remedy of the purchasers and the sole liability of Intersan under this warranty. Intersan shall not otherwise be liable for any indirect damages caused by defects in the repair or replacement thereof.
5. This warranty extends only to commercial and institutional purchasers and does not extend to any others, including consumer customers of commercial institutional purchasers.
6. This warranty is in lieu of all other warranties, expressed or implied, including any implied warranty of merchantability or fitness for a particular purpose or otherwise.



**INTERNATIONAL SANITARY WARE MANUFACTURING CO.**